



OBERDORFER
by Gardner Denver

LEAD-FREE PEDESTAL ROTARY GEAR PUMPS
FOR MAPLE SYRUP APPLICATIONS

Model OBNL9000L

PERFORMANCE CURVE

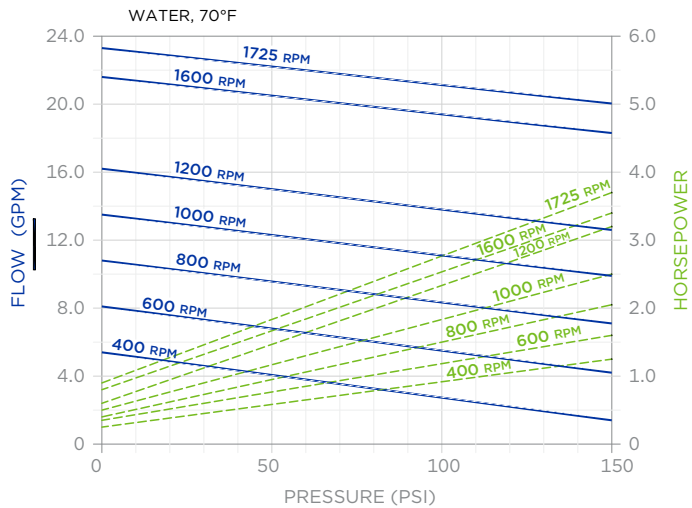

DIMENSIONS

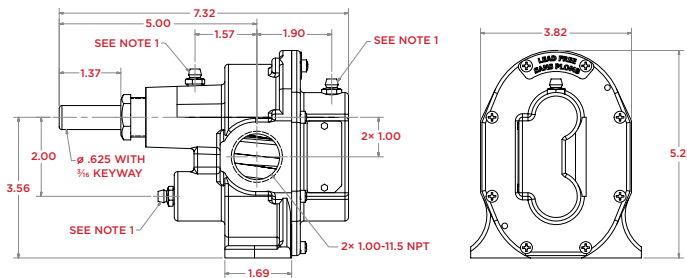

NOTE:

1) Grease fittings (item 4) installed into .125-27 NPT connections.

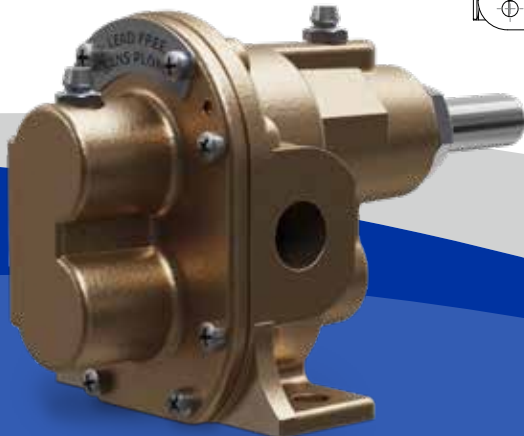
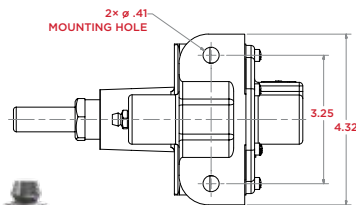

Features

- Lead-free corrosion-resistant castings
- Helical gears for quiet operation
- Stainless steel shafts and fasteners
- Synthetic braided compression packing (with PTFE dispersion)
- 1" NPT ports

Mounting & Drive Arrangement

Pumps should be mounted on a rigid base and properly aligned with the motor. Direct drive via flexible shaft coupling is the preferred method. When a belt drive is needed, additional support is necessary to absorb the added pulley load.

Liquids & Temperature

Service life will be increased substantially if the liquid pumped is clean and has some degree of lubricity. These positive displacement pumps have tight tolerances.

Temperature extremes are detrimental to service life and should be avoided. Basic metals of construction allow a temperature range of -40 to 220°F. Allowing a liquid to freeze in the pump can cause damage.

Suction Lift

Close tolerances and the positive pumping action make the rotary gear pump capable of lifting water on the suction side as high as 20 feet. Though gear pumps are self priming, a foot valve is recommended. If possible, wet the gears with liquid to be pumped for the first dry start. Liquid retained in the system and gear chambers serves to "wet" the pump on subsequent starts. When possible flush pumps after usage.

PARTS LIST - OBNL9000L

ITEM NO.	DESCRIPTION	COMPONENT NO.	QTY.
1	Packnut	OB1762-01	1
2	Packing	OB5479	2
3	Body	OB9318BC1N-1	1
4	Grease Fitting	OB5390-01	3
5	Drive Shaft & Gear Assy	OB50039	1
6	Idle Shaft & Gear Assy	OB50040	1
7	O-Ring	OB9797-045	1
8	Cover	OB9326BN5N-1	1
9	Screw	OB5385	8
10	Dowel Pin	OB8885	2
11	Pump Tag	OB9344	1
12	Tag Screw	OB9345	2
13	Lead Free Tag	OB50004	1

REPAIR KIT	
Part No.	OBNL9000LK
Items Included	2, 5, 6 & 7

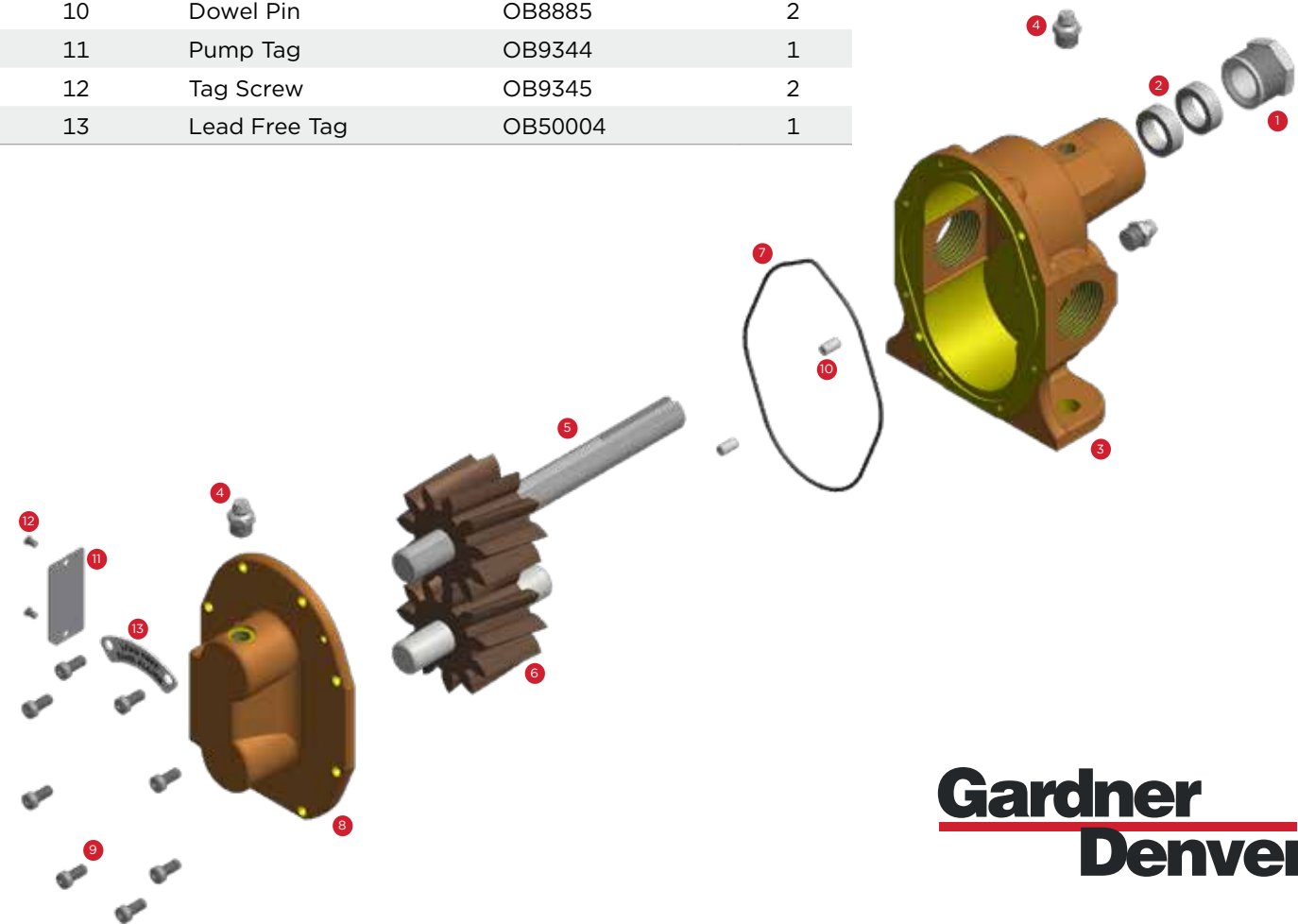

Gardner Denver®

Gardner Denver, Inc.

5900 Firestone Drive
Syracuse, NY 13206
800-448-1668

oberdorfermail@gardnerdenver.com

www.oberdorferpumps.com



©2018 Gardner Denver, Inc. Printed in U.S.A.
OB-OBNL9000L 1st Ed. 11/18

Please recycle after use.